



## SPECIFICATIONS:

OPERATING VOLTAGE: 24V DC max.  
 SWITCHING CURRENT: 100mA max. RxJ 15mA max.  
 CARRYING CURRENT: 0.5A max.  
 CONTACT RESISTANCE: 100mΩ max.  
 INSULATION RESISTANCE: 1,000MΩ min. RxJ 100MΩ  
 DIELECTRIC STRENGTH: 300VAC for 1 min.  
 OPERATING TEMPERATURE: -10°C to +70°C.  
 SOLDERING TEMPERATURE: 250 ± 5°C for 5 sec.  
 LIFE: 10,000 step operations min.

## MATERIALS:

HOUSING & KNOB: Thermoplastic.  
 PRINTED CIRCUIT BOARDS: Hard gold plated over nickel plated on epoxy fiberglass.  
 CONTACTS & TERMINATIONS: Precious metal on phosphor bronze.

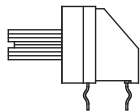

R1

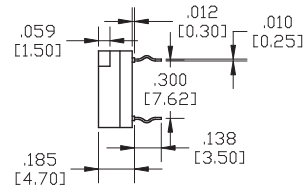
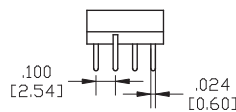
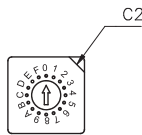
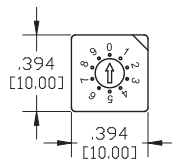
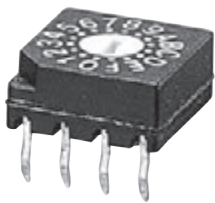

P.C.MOUNTING

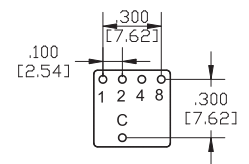

R1J

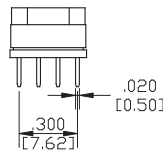
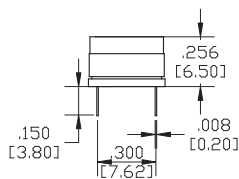
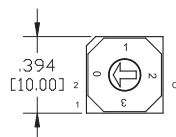

04  
BCD-4 POSITION

POSITION	Common C contacted		
	C	1	2
0	●		
1	●	●	
2	●		●
3	●	●	●

P.C.MOUNTING

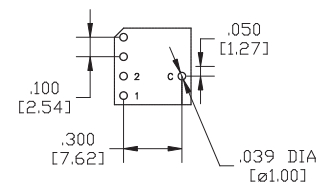

R2

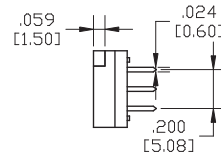
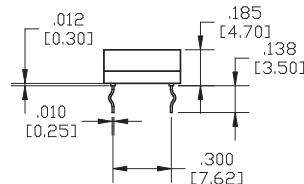
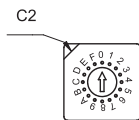
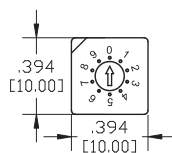
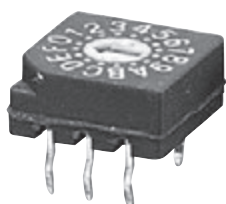

P.C.MOUNTING

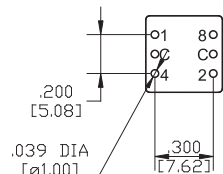

## R2J

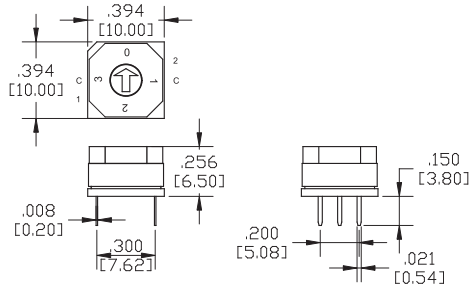

### 04 BCD-4 POSITION

POSITION	Common C contacted ●		
	C	1	2
0	●		
1	●	●	
2	●		●
3	●	●	●

### P.C.MOUNTING

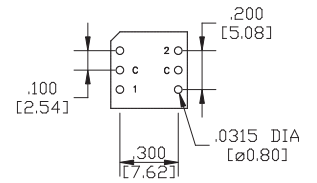

## ACTUATOR OPTIONS

### T1 FLUSH

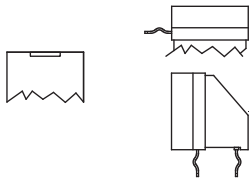

### T2

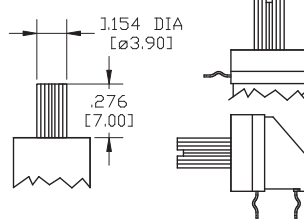

### T3

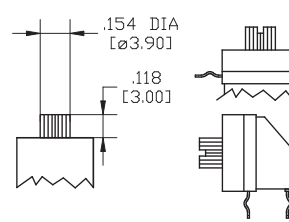

### T4 (RxJ ONLY)

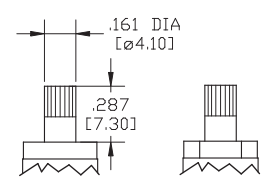

## R3

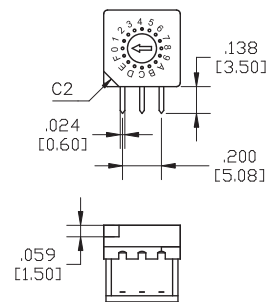
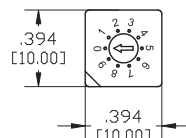

### P.C.MOUNTING

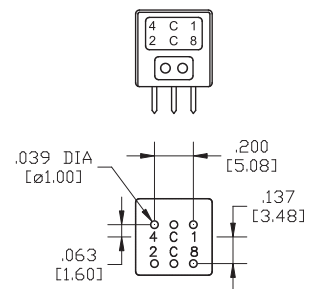

## R3J

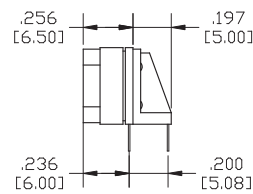
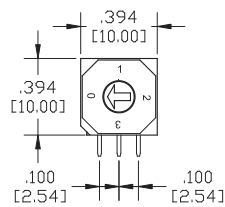

### 04 BCD-4 POSITION

POSITION	Common C contacted ●		
	C	1	2
0	●		
1	●	●	
2	●		●
3	●	●	●

### P.C.MOUNTING

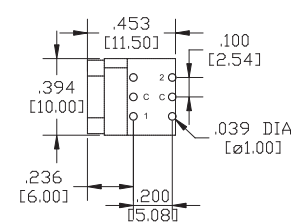

## R4

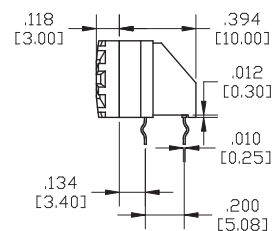
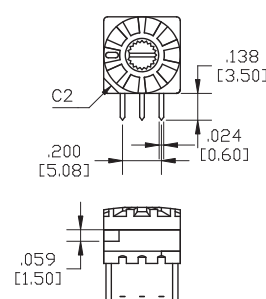
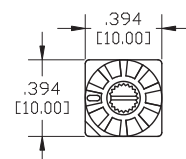

### P.C.MOUNTING

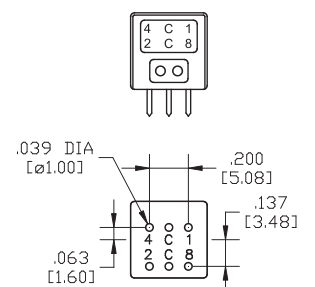

Toggle

Rocker

Slide

Pushbutton

AV

Rotary

Tact

Touch Key

Miscellaneous

R5

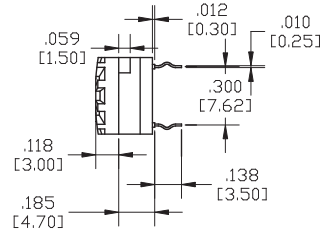
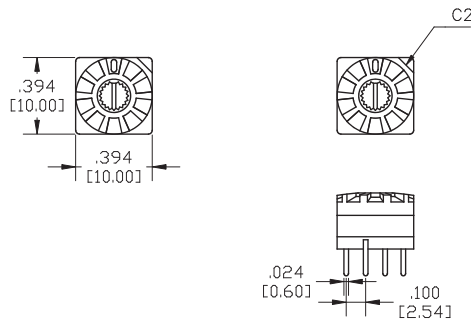
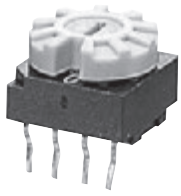

P.C.MOUNTING

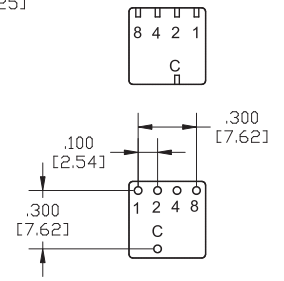

R6

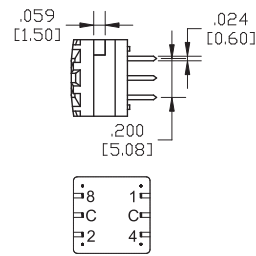
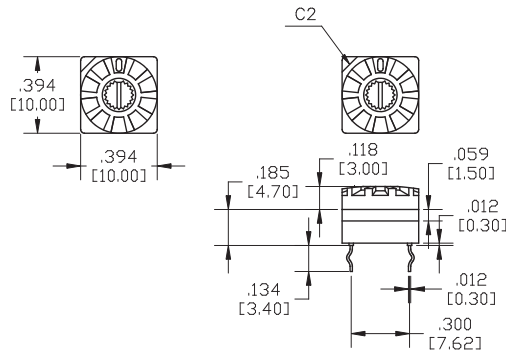
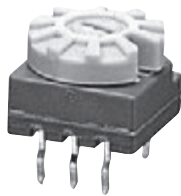

P.C.MOUNTING

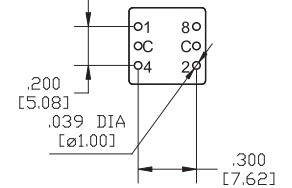

R7J

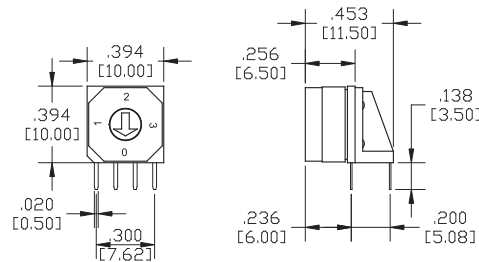

04 BCD-4 POSITION

POSITION	Common C contacted ●	
	C	2
0	●	
1	●	●
2	●	
3	●	●

P.C.MOUNTING

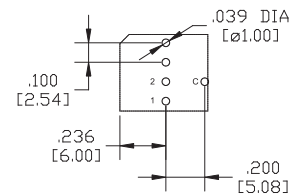

R1B

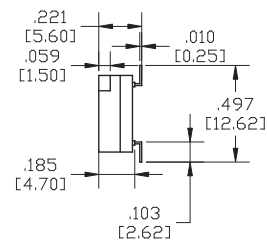
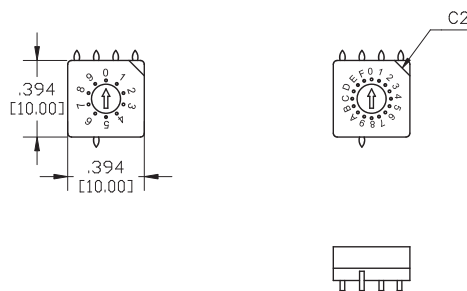
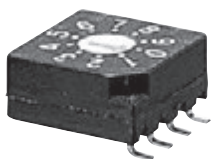

SURFACE MOUNTING

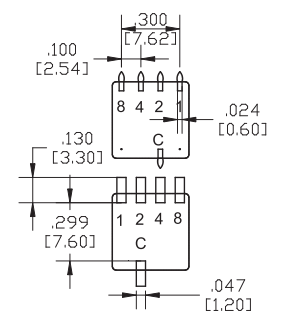

R1BJ

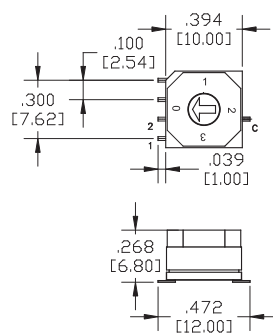

04 BCD-4 POSITION

POSITION	Common C contacted ●	
	C	2
0	●	
1	●	●
2	●	
3	●	●

SURFACE MOUNTING

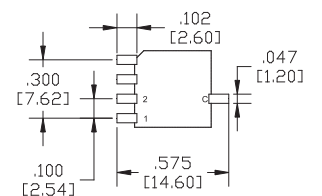

# Series 900A

# Rotary Dip Switches

R2B

SURFACE MOUNTING

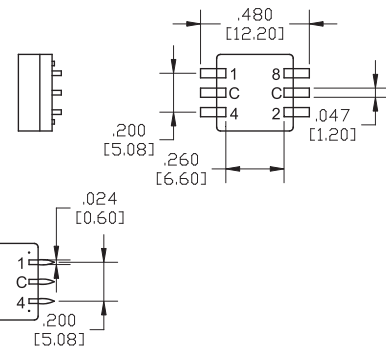
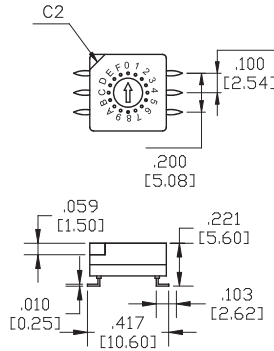
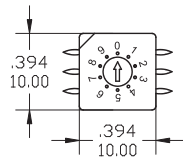

R2BJ

SURFACE MOUNTING

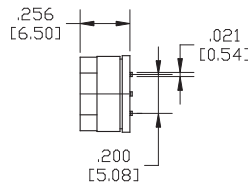
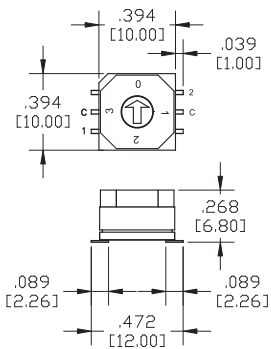

04  
BCD-4 POSITION

POSITION	Common C contacted ●	1	2
0	●		
1		●	
2			●
3		●	●

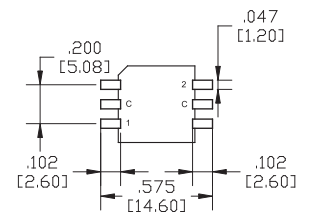

## CODES (NOT FOR RxJ MODEL)

CODE NO:11  
BCD-8 POSITION

Position	Common C contacted ●				
	1	2	4	8	C
0					●
1	●				●
2		●			●
3	●	●			●
4			●		●
5	●		●		●
6		●	●		●
7	●	●	●		●
7	●	●	●		●

CODE NO:12  
BCD-10 POSITION

Position	Common C contacted ●				
	1	2	4	8	C
0					●
1	●				●
2		●			●
3	●	●			●
4			●		●
5	●		●		●
6		●	●		●
7	●	●	●		●
8				●	●
9	●			●	●

CODE NO:14  
BCD-16 POSITION

Position	Common C contacted ●				
	1	2	4	8	C
0					●
1	●				●
2		●			●
3	●	●			●
4			●		●
5	●		●		●
6		●	●		●
7	●	●	●		●
8				●	●
9	●			●	●
A		●			●
B	●	●			●
C			●		●
D	●	●	●		●
E		●		●	●
F	●	●	●		●

CODE NO:31  
BCD COMP.-10 POS.

Position	Common C contacted ●				
	1	2	4	8	C
0	●	●	●	●	●
1		●	●	●	●
2	●		●	●	●
3			●	●	●
4	●	●		●	●
5		●		●	●
6	●			●	●
7				●	●
8	●	●	●		●
9		●	●		●

CODE NO:33  
BCD COMPLEMENT-16 POS.

Position	Common C contacted ●				
	1	2	4	8	C
0	●	●	●	●	●
1		●	●	●	●
2	●		●	●	●
3			●	●	●
4	●	●		●	●
5		●		●	●
6	●			●	●
7				●	●
8	●	●	●		●
9		●	●		●
A	●			●	●
B		●		●	●
C	●	●	●		●
D		●		●	●
E	●			●	●
F		●	●		●

## HOW TO ORDER

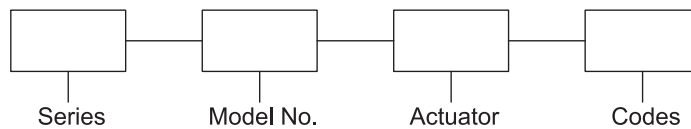

(G)Grey / (W)White Actuator = Positive Logic

(R)Red / (P)Pink Actuator = Negative Logic