

## SPECIFICATIONS:

CONTACT RATING: Refer to "Contact Material Options" for more info.  
 ELECTRICAL LIFE: 50,000 make and break cycles at full load.  
 CONTACT RESISTANCE: 10mΩ max. initial @2-4VDC  
 INSULATION RESISTANCE: 1,000MΩ min.  
 DIELECTRIC STRENGTH: 1,500V RMS @ sea level.  
 OPERATION TEMPERATURE: -30°C to +85°C.

## MATERIALS:

CASE: Diallyl phthalate(DAP)(UL 94V-0).  
 PLUNGER: Polybutylene terephthalate (PBT) or Nylon (UL 94V-0).  
 FRAME: Nylon 6/6 (UL 94HB), black standard.  
 BUTTON & CAP: Nylon 6/6 or ABS, black standard.  
 BUSHING: Brass, nickel plated.  
 HOUSING: Stainless steel.  
 TERMINAL SEAL: Epoxy.

Specifications and Dimensions subject to change

If your preferred product configuration is not shown, please contact our sales representative for custom design.

## HOW TO ORDER SYSTEM

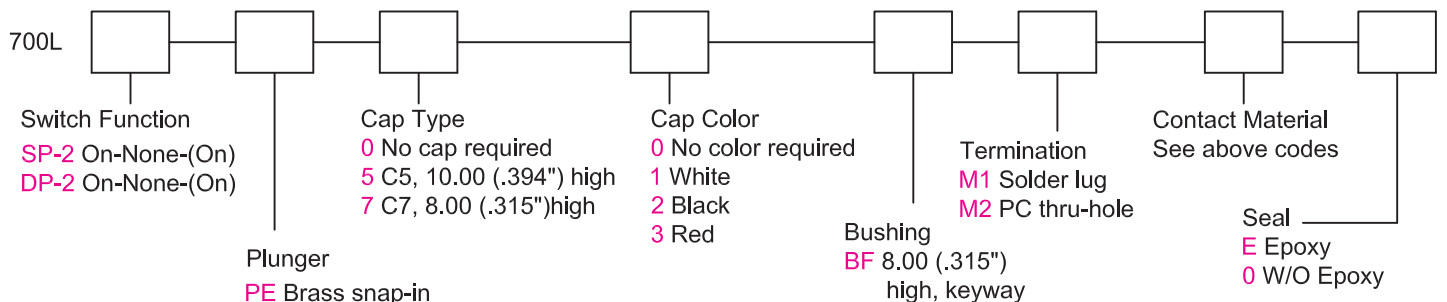
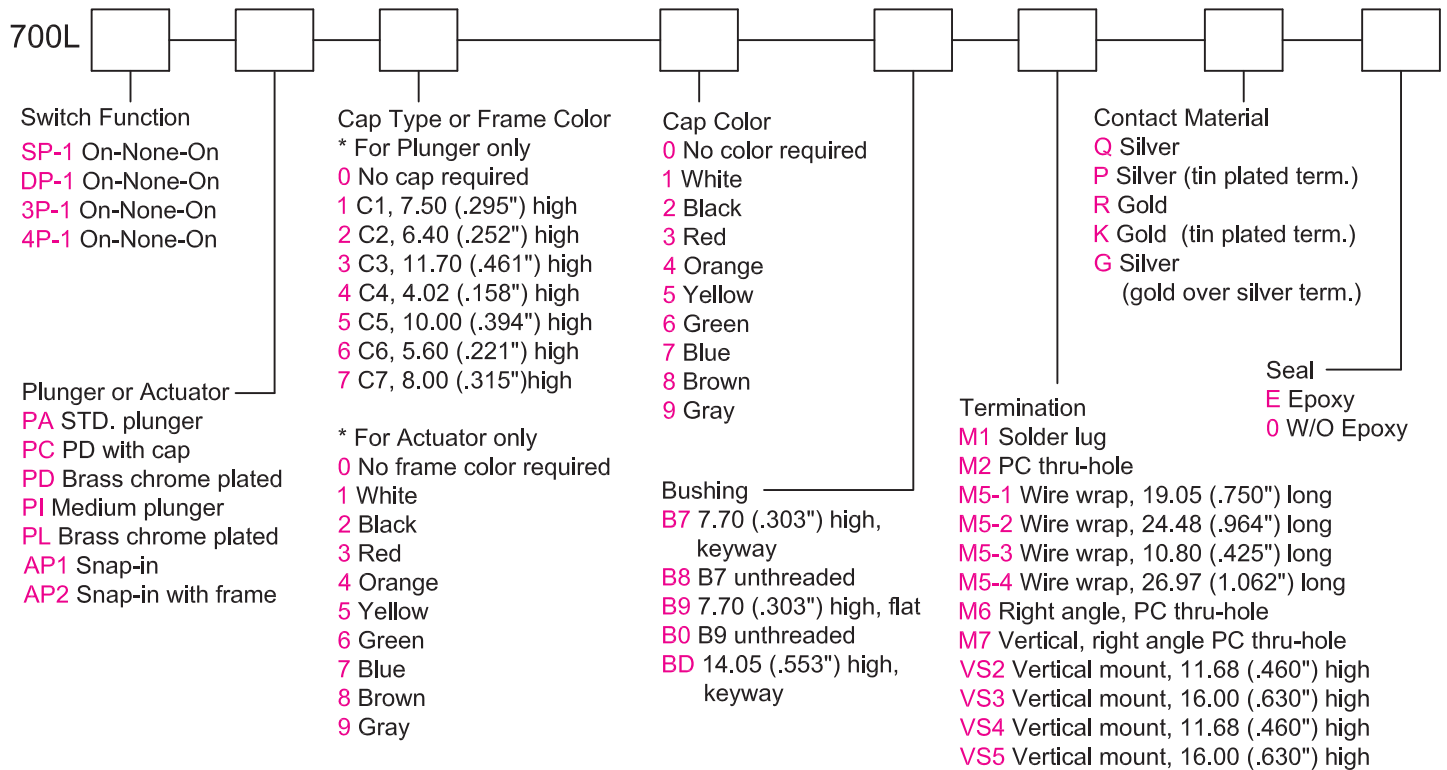

Toggle

Rocker

Slide

Pushbutton

AV

Rotary

Tact

Touch Key

Miscellaneous

# Series 700L

# Alternate Acting Pushbutton Switches

## SPDT



Model No.	Switching Position		
<b>SP-1</b>	ON	NONE	ON
Term. Comm.	2-3	OPEN	2-1

Schematic

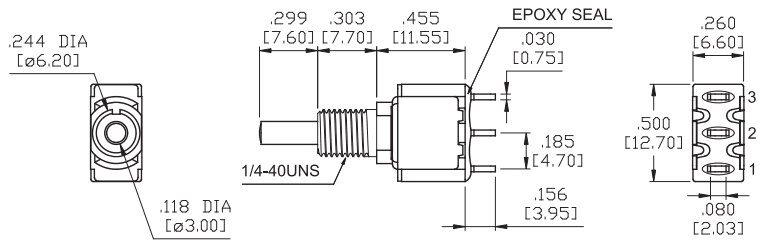

## SPDT



Model No.	Switching Position		
<b>SP-2</b>	ON	NONE	(ON)
Term. Comm.	2-3	OPEN	2-1

Schematic

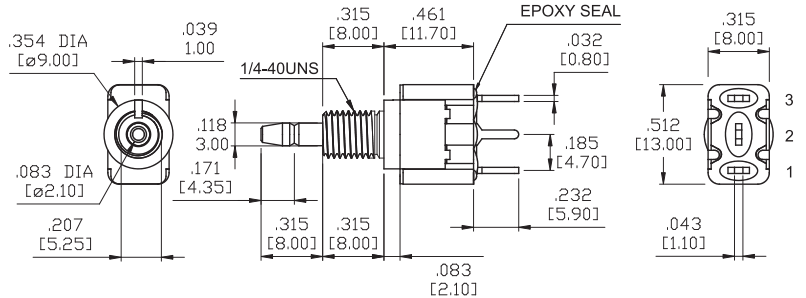

## DPDT



Model No.	Switching Position		
<b>DP-1</b>	ON	NONE	ON
Term. Comm.	2-3,5-6	OPEN	2-1,5-4

Schematic

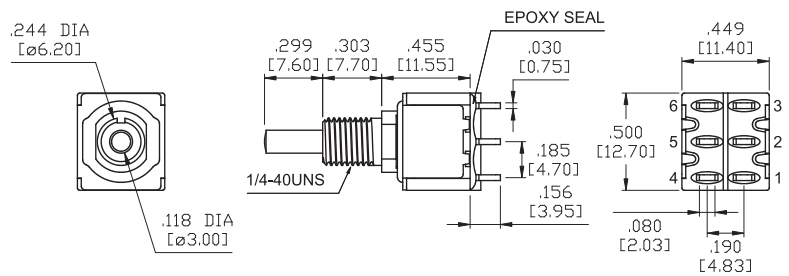
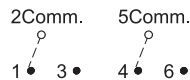

## DPDT



Model No.	Switching Position		
<b>DP-2</b>	ON	NONE	(ON)
Term. Comm.	2-3,5-6	OPEN	2-1,5-4

Schematic

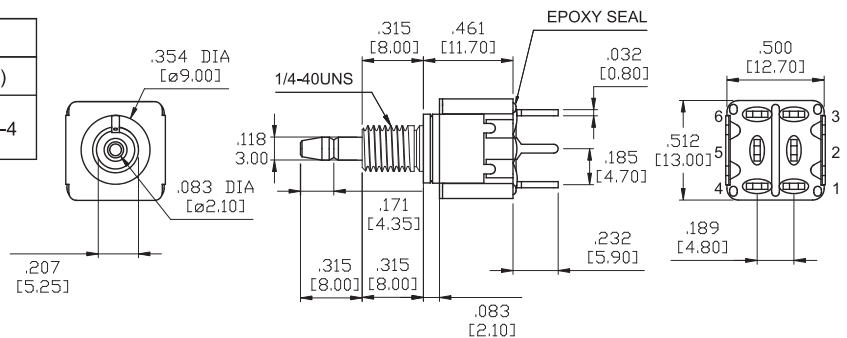
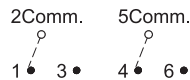

## 3PDT



Model No.	Switching Position		
<b>3P-1</b>	ON	NONE	ON
Term. Comm.	2-3,5-6 8-9	OPEN	2-1,5-4 8-7

Schematic

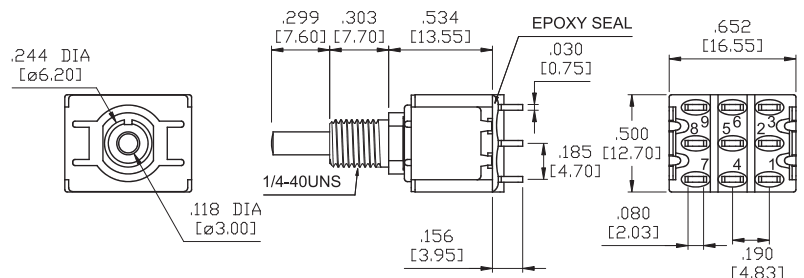

# Series 700L

# Alternate Acting Pushbutton Switches

4PDT



Model No.	Switching Position		
4P-1	ON	NONE	ON
Term. Comm.	2-3,5-6 8-9 11-12	OPEN	2-1,5-4 8-7 11-10

Schematic

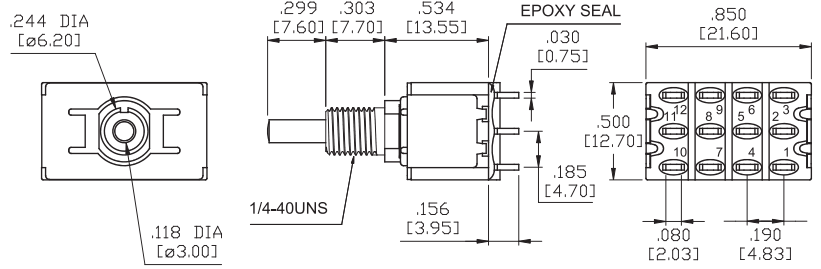
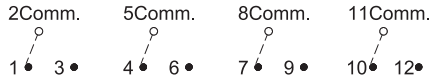

## ACTUATOR OPTIONS FOR SNAP-IN FRONT MOUNT

AP1

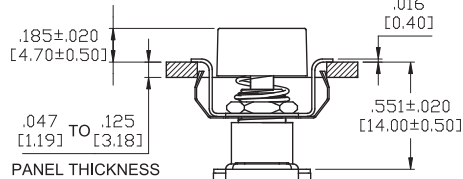
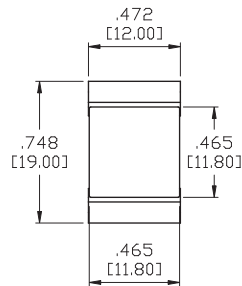

PANEL MOUNTING

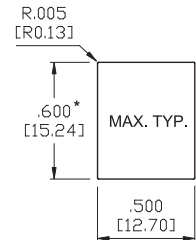

\* Increase this dimension to .620/.625 [15.75/15.88] for .091/.125 [2.31/3.18] thk. panels.

AP2 WITH FRAME

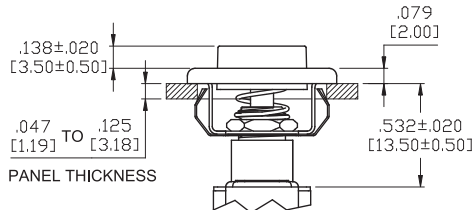
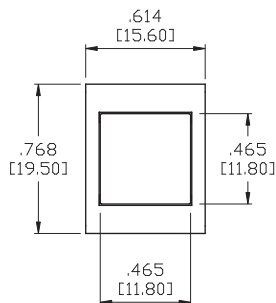
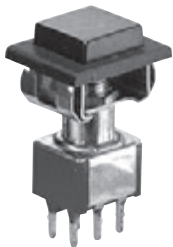

PANEL MOUNTING

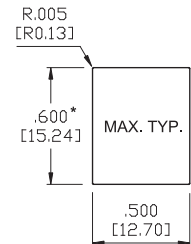

\* Increase this dimension to .620/.625 [15.75/15.88] for .091/.125 [2.31/3.18] thk. panels.

## PLUNGER OPTIONS (SP-1 & DP-1 MODEL)

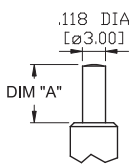

OPTION CODE	DIM "A"
PA	.299 [7.60]
PI	.244 [6.20]

PL

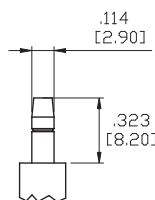

\* Plunger material: Brass Nickel Plated

PC

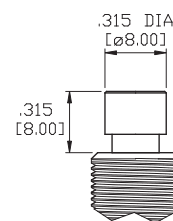

\* Plunger material: Brass Chrome Plated  
 \* PC,PD must configure with BD bushing

PD

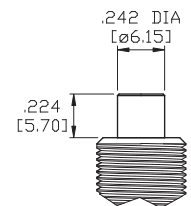

Toggle  
Rocker  
Slide  
Pushbutton  
AV  
Rotary  
Tact  
Touch Key  
Miscellaneous

## BUSHING OPTIONS (SP-1 & DP-1 MODEL)

**B7 THD STD**  
**B8 NON-THD**

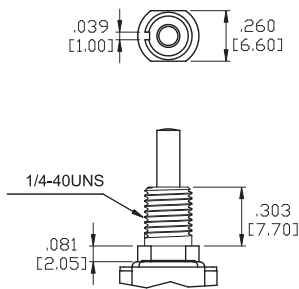

**B9 THD STD**  
**B0 NON-THD**

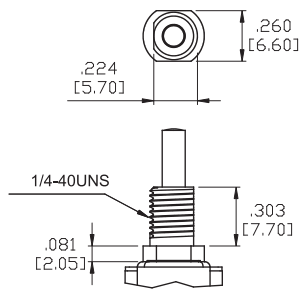

**BD THD STD**

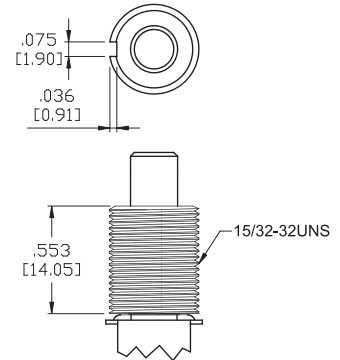

## TERMINATION OPTIONS (SP-1 & DP-1 MODEL)

**M1 STD. SOLDER LUG**

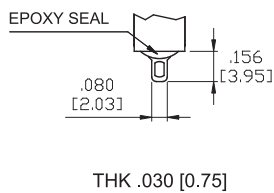

**M2 PC-THRU HOLE**

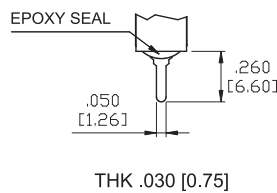

**M5 WIRE WRAP**

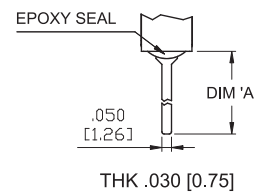

OPTION CODE	DIM.'A'
M5-1	.750 [19.05]
M5-2	.964 [24.48]
M5-3	.425 [10.80]
M5-4	1.062 [26.97]

**M6**

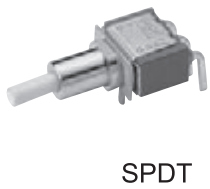

SPDT

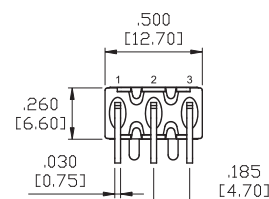
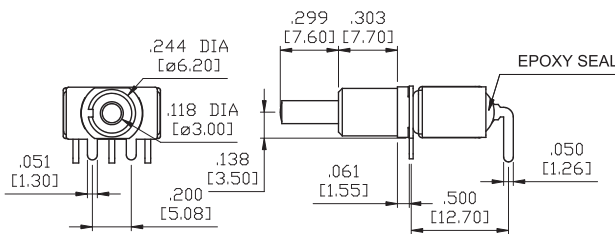

**P.C.MOUNTING**

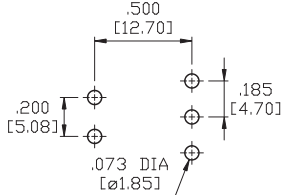

**M6**

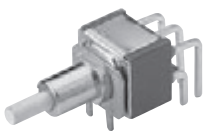

DPDT

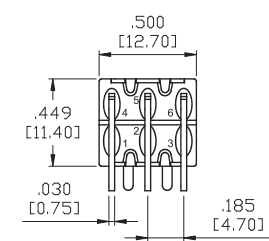
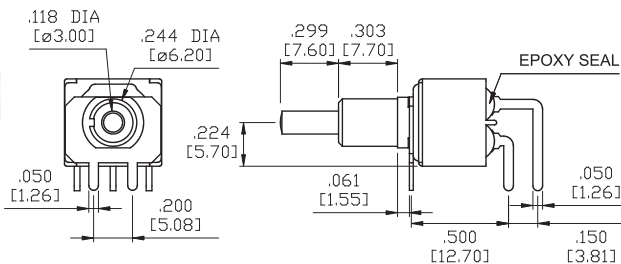

**P.C.MOUNTING**

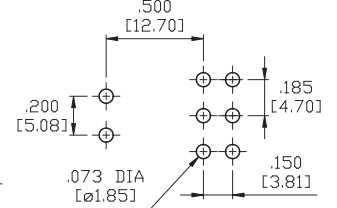

**M7**

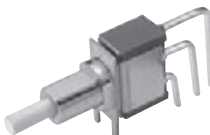

SPDT

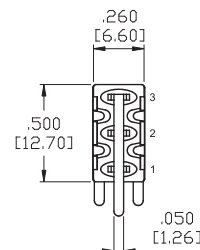
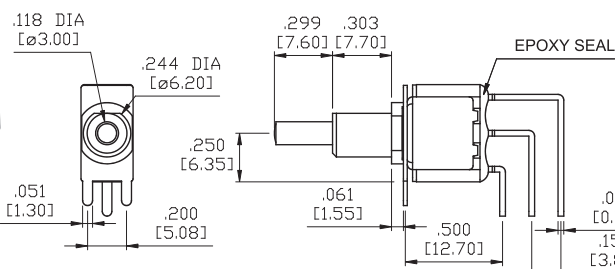

**P.C.MOUNTING**

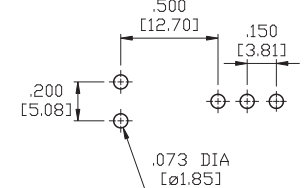

# Series 700L

# Alternate Acting Pushbutton Switches

M7

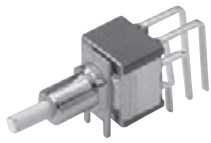

DPDT

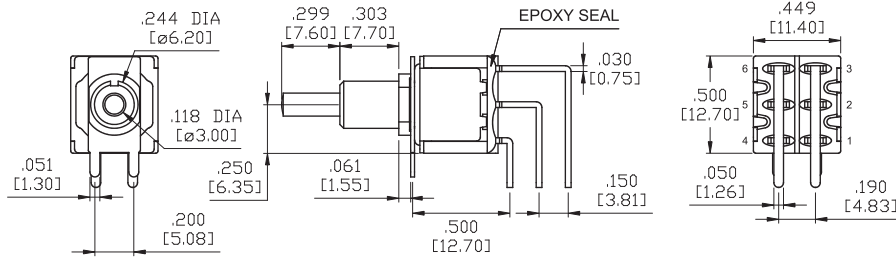

P.C.MOUNTING

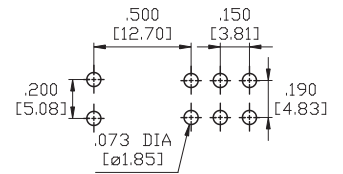

M7

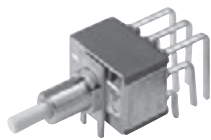

3PDT

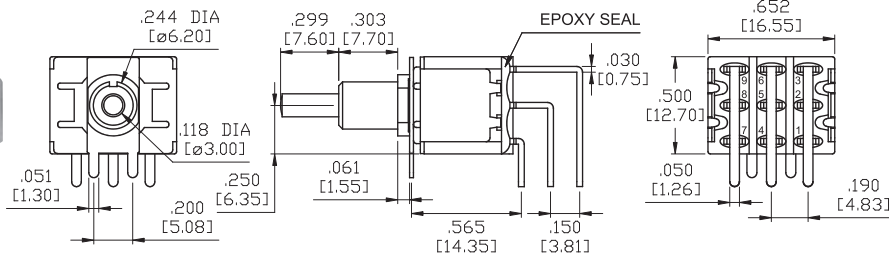

P.C.MOUNTING

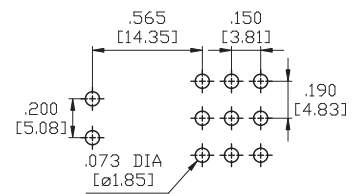

M7

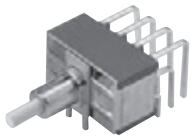

4PDT

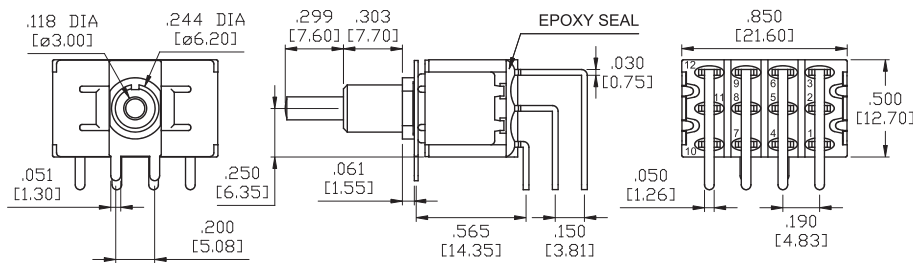

P.C.MOUNTING

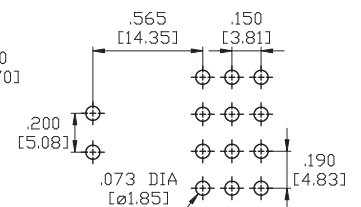

VS2-VS3

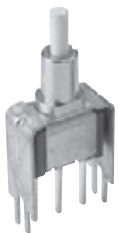

SPDT

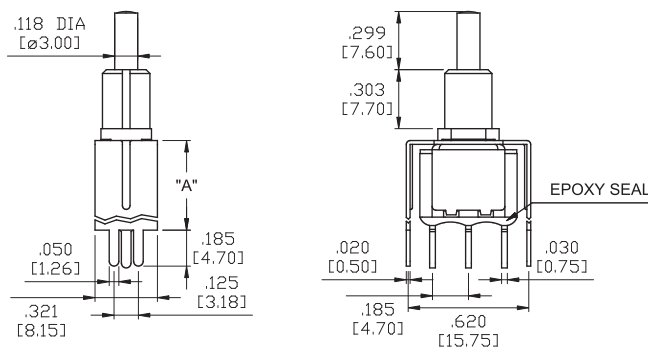

P.C.MOUNTING

OPTION CODE	DIM.'A'
VS2	.461 [11.70]
VS3	.630 [16.00]

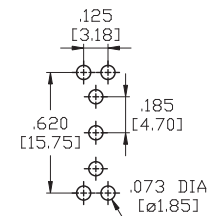

VS2-VS3



DPDT

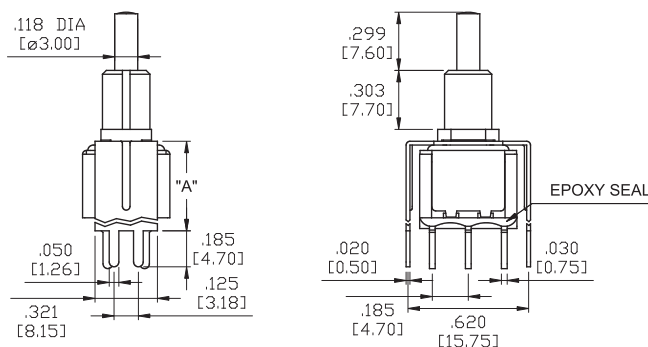

P.C.MOUNTING

OPTION CODE	DIM.'A'
VS2	.461 [11.70]
VS3	.630 [16.00]

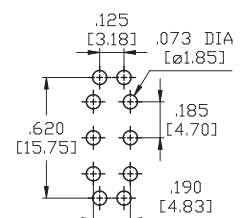

Toggle

Rocker

Slide

Pushbutton

AV

Rotary

Tact

Touch Key

Miscellaneous

# Series 700L

# Alternate Acting Pushbutton Switches

VS4-VS5

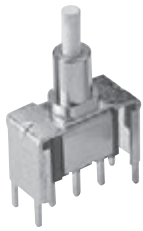

SPDT

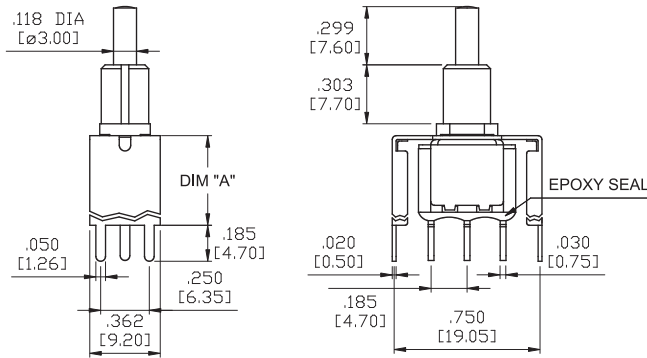

OPTION CODE	DIM.'A'
VS4	.461 [11.70]
VS5	.630 [16.00]

P.C.MOUNTING

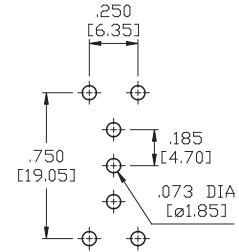

VS4-VS5



DPDT

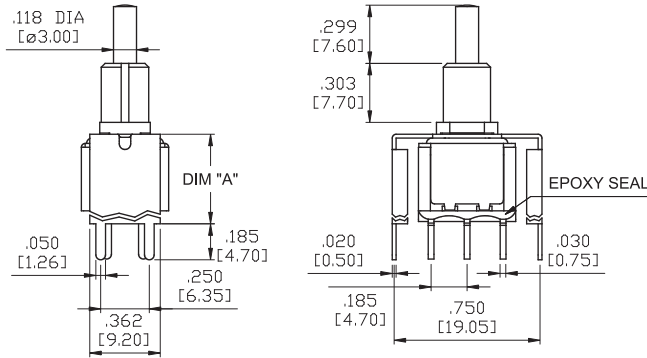

OPTION CODE	DIM.'A'
VS4	.461 [11.70]
VS5	.630 [16.00]

P.C.MOUNTING

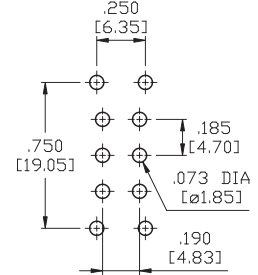

## PLUNGER CAPS

C1

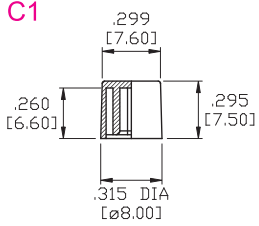

C2

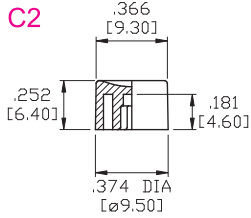

C3

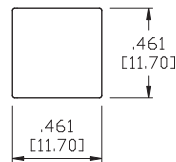

C4

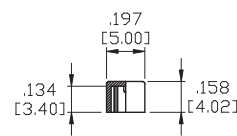

C5

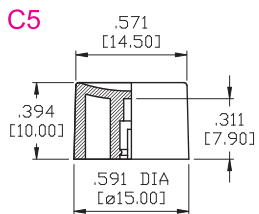

For PL plunger only

C6

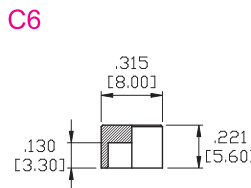

For PD plunger only

C7

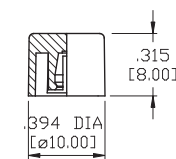

For PL plunger only

### CAP AND FRAME COLORS

1	White
2	Black
3	Red
4	Orange
5	Yellow
6	Green
7	Blue
8	Brown
9	Gray

MATERIAL: ABS for C1~C5.  
MATERIAL: Brass for C6  
Chrome or nickel plated.

## PANEL MOUNTING

1/4 INCH BUSHING

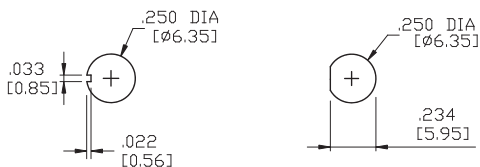

15/32 INCH BUSHING

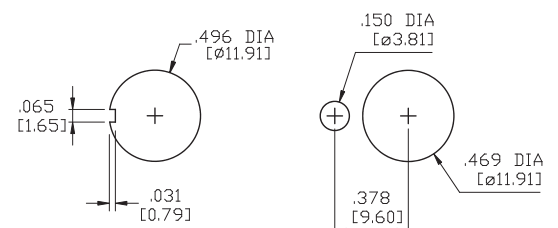

## HARDWARE

### NUT

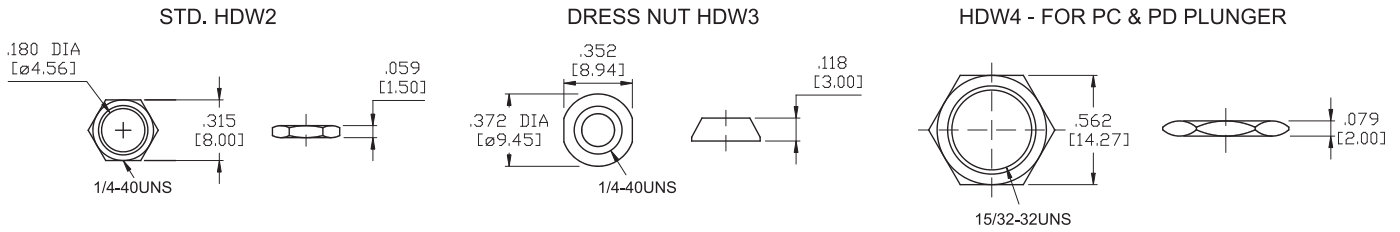

### LOCKING RING

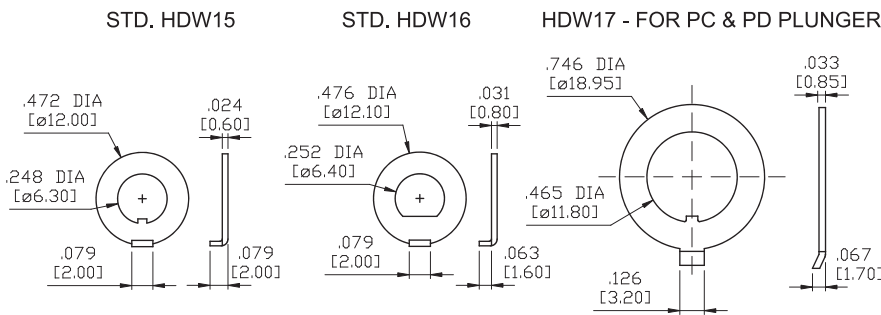

### LOCK WASHER

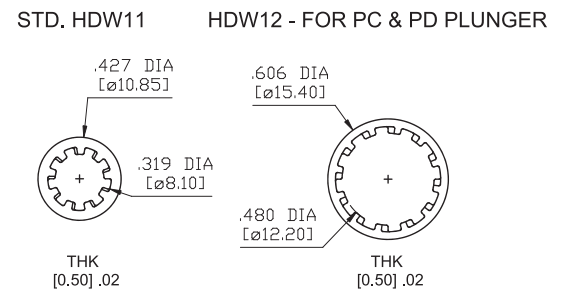

## CONTACT MATERIAL OPTIONS

Coding	Contact Material	Terminal Plating	Rating	Agency Approvals
Q	Silver <sup>1</sup>	Silver plated <sup>6</sup>	6Amps @ 125VAC or 28VDC 3Amps @ 250VAC	
P		Tin plated <sup>5/8</sup>		
R	Gold <sup>2</sup>	Gold plated <sup>4</sup>	0.4VA max @ 20V max (AC or DC)	
K		Tin plated <sup>5/7</sup>		
G	Silver <sup>1</sup>	Gold over silver <sup>3</sup>	6Amps @ 125VAC or 28VDC 3Amps @ 250VAC	

1. Movable Contact: Coin silver, silver plated.
2. Movable Contact: Copper alloy with gold plated over nickel plated.
3. Terminals: Silver plated with outer layer in gold plating.
4. Terminals: Copper alloy, with gold plated over nickel plated.
5. Outer Terminals: Copper alloy with pure tin plated.
6. Terminals: Copper alloy, silver plated.
7. Terminal Contact: Gold plated over nickel plated.
8. Terminal Contact: Palladium nickel alloy (or Silver) plated.

\* P, K not available with M1 termination.